



# Wild Earth Travel

*Small Ships, Big Adventures*

**wildearth-travel.com**

**info@wildearth-travel.com**

## QUEST FOR THE ANTARCTIC CIRCLE - AN IN-DEPTH EXPLORATION OF THE ANTARCTIC PENINSULA

Experience an in-depth exploration of the Antarctic Peninsula with the pioneers of Antarctic cruising, featuring nine days on the continent--our longest, most comprehensive Antarctica experience available. This is the pinnacle of expeditionary travel as we push further south into rarely visited territory in pursuit of the Antarctic Circle. National Geographic Endurance, your home base for the adventure, is purpose-built to offer unprecedented access to these rarified places, and our diverse team of experts will ensure we maximize our time in the region. Along the way, Zodiac cruise around enormous icebergs, watch for whales off the bow, kayak in tranquility, and hike onshore. Choose an active agenda or surrender to the pleasures of relaxing downtime and shipboard camaraderie. Plus, get top shots with the help of a National Geographic Photography Expert.

Wild Earth Travel

*Small Ships, Big Adventures*

**0800 945 3327** (within New Zealand) | +64 (0) 3 365 1355 | **1800 107 715** (within Australia)

info@wildearth-travel.com | **wildearth-travel.com**

# Wild Earth Travel

*Small Ships, Big Adventures*

[wildearth-travel.com](http://wildearth-travel.com)

[info@wildearth-travel.com](mailto:info@wildearth-travel.com)



Arrival City: Buenos Aires, Argentina

## Day 2 Fly to Ushuaia, Argentina / Embark Ship

Fly to Ushuaia, the southernmost city in the world. Enjoy lunch on a catamaran cruise of the Beagle Channel. Embark National Geographic Endurance.

Meals Included: Breakfast, Lunch, Dinner

## Days 3-4 At Sea Crossing the Drake Passage

This 500-mile-wide strait between South America and the Antarctic Peninsula is one of the most famous bodies of water in the world. Sometimes ferocious, sometimes flat calm, the Drake is always a fascinating place in its own right. This part of the journey is our best opportunity to see gorgeous seabirds like the wandering albatross, and we might be lucky enough to encounter killer whales or rare species of dolphins. This is also a day to get to know our ship and prepare for the adventures ahead. Visit the Bridge (a great place to spot wildlife), have a relaxing massage, attend a talk about the biology of the penguins you'll soon be seeing, or settle into a comfy chair in the observation lounge, look out over the waves and reflect on the incredible history of this fabled passage. If it does get a little rough, just take a couple of nice naps; we'll be in Antarctica before you know it.

Meals Included: Breakfast, Lunch, Dinner

## Days 5-13 Deep Exploration Towards the Antarctica Circle

With long hours of daylight at this time of year, and nine days on the Continent, we can experience more as we sail in the wake of history's boldest explorers on a quest to cross the legendary Antarctic Circle. Our schedule is flexible, and our state-of-the-art ship allows us to get deeper and go further to take advantage of the unexpected, whether we're watching whales at play off the bow of our ship, walking amid thousands of Adelie and gentoo penguins, enjoying an evening Zodiac cruise under the spectacular midnight sun, or even discovering a new uncharted cove. While wildlife is magnificent, ice defines the

## ITINERARY

### Day 1 Buenos Aires, Argentina

Arrive Buenos Aires. Transfer from the airport to the Alvear Icon or similar.

Arrival Time: Arrive before 11:30 a.m. local time.

Wild Earth Travel

*Small Ships, Big Adventures*

0800 945 3327 (within New Zealand) | +64 (0) 3 365 1355 | 1800 107 715 (within Australia)

[info@wildearth-travel.com](mailto:info@wildearth-travel.com) | [wildearth-travel.com](http://wildearth-travel.com)



# Wild Earth Travel

*Small Ships, Big Adventures*



**wildearth-travel.com**

**info@wildearth-travel.com**

Antarctic. You'll get to know ice up close and personal--from icebergs the size of islands, bergy bits and near-vertical glaciers, to the fragile, nearly invisible layers that have just begun to freeze.

One day, we might set out by kayak to encounter towering icebergs at water level or embark on a Zodiac excursion in search of seals and blue-eyed shags. The next, we might experience the thrill of the ship crunching through pack ice. Everywhere we go in Antarctica we're surrounded by opportunities to capture uniquely beautiful images. Along the way your expert expedition team will enrich your experiences and our Icemaster Captain will navigate you safely through these icy waters.

Meals Included: Breakfast, Lunch, Dinner

## Days 14-15 At Sea

Enjoy the ship's amenities as the coast of Antarctica disappears from view. Round the southernmost tip of South America and see the meeting of the Atlantic and Pacific Oceans. Take some time to go through your photos. Send a message home to friends and family saying: "Don't want this to end!" And celebrate your voyage at a farewell dinner on board.

Meals Included: Breakfast, Lunch, Dinner

## Day 16 Ushuaia / Disembark Ship / Buenos Aires

Today we disembark in Ushuaia. Fly to Buenos Aires and connect with your overnight flight home.

Departure Time: Depart after 9:00 p.m. local time.

Departure City: Buenos Aires, Argentina

Meals Included: Breakfast

## Please note:

Itineraries are subject to change.



**0800 945 3327** (within New Zealand) | +64 (0) 3 365 1355 | **1800 107 715** (within Australia)

info@wildearth-travel.com | **wildearth-travel.com**



# Wild Earth Travel

*Small Ships, Big Adventures*

**wildearth-travel.com**

**info@wildearth-travel.com**

## YOUR SHIP: NATIONAL GEOGRAPHIC ENDURANCE

<b>YOUR SHIP:</b>	<b>National Geographic Endurance</b>
<b>VESSEL TYPE:</b>	<b>Expedition Ship</b>
<b>LENGTH:</b>	<b>124 m</b>
<b>PASSENGER CAPACITY:</b>	<b>126</b>
<b>BUILT/REFURBISHED:</b>	<b>2020</b>

National Geographic Endurance is a state-of-the-art expedition vessel purpose-built for year-round polar navigation. Named in honour of Sir Ernest Shackleton's legendary Endurance expedition, she is the first polar ship in Lindblad's history designed from the keel up for exploration. With an ice-class rating of PC5 (Category A) and a fully stabilised hull, she grants access to remote and often uncharted corners of the Arctic and Antarctica in exceptional comfort and safety.

Her revolutionary X-Bow®--a striking forward-leaning design--enables superior wave-cutting performance, ensuring a smoother, quieter ride and minimising spray on deck for better wildlife observation. On board, guests enjoy thoughtfully designed public spaces including a wraparound observation lounge, library, and an expedition base for gear and briefings. Dining is offered across three flexible venues, all serving sustainable, locally inspired cuisine. With a full suite of tools for exploration and a design deeply rooted in expedition heritage, Endurance is the ultimate platform for discovering Earth's most remote regions.



Wild Earth Travel

*Small Ships, Big Adventures*

**0800 945 3327** (within New Zealand) | +64 (0) 3 365 1355 | **1800 107 715** (within Australia)

info@wildearth-travel.com | **wildearth-travel.com**

# Wild Earth Travel

*Small Ships, Big Adventures*

[wildearth-travel.com](http://wildearth-travel.com)

[info@wildearth-travel.com](mailto:info@wildearth-travel.com)

## INSIDE YOUR SHIP

### Observation Deck

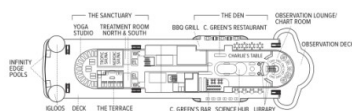

### Bridge Deck

Category 5  
Category 6  
Category 7



### Lounge Deck

Category 4  
Category B Solo



### Main Deck

Category 3  
Category 2 Solo



### Fore Deck

Category 1  
Category 2



### Expedition Deck



### Category 1. From



Wild Earth Travel

*Small Ships, Big Adventures*

0800 945 3327 (within New Zealand) | +64 (0) 3 365 1355 | 1800 107 715 (within Australia)

[info@wildearth-travel.com](mailto:info@wildearth-travel.com) | [wildearth-travel.com](http://wildearth-travel.com)



# Wild Earth Travel

*Small Ships, Big Adventures*



**wildearth-travel.com**

**info@wildearth-travel.com**

## PRICING

**11-Jan-2027 to 26-Jan-2027**

<b>Category 1. From</b>	<b>41269 AUD pp</b>
-------------------------	---------------------

<b>More Cabin Categories &amp; Prices Available</b>	<b>0 pp</b>
---	-------------

**25-Jan-2027 to 09-Feb-2027**

<b>Category 1. From</b>	<b>41269 AUD pp</b>
-------------------------	---------------------

<b>More Cabin Categories &amp; Prices Available</b>	<b>0 pp</b>
---	-------------



**Wild Earth Travel**

*Small Ships, Big Adventures*

**0800 945 3327** (within New Zealand) | +64 (0) 3 365 1355 | **1800 107 715** (within Australia)

info@wildearth-travel.com | **wildearth-travel.com**