

# Wild Earth Travel

*Small Ships, Big Adventures*

**wildearth-travel.com**

**info@wildearth-travel.com**

## VOYAGE TO ANTARCTICA: THE WHITE CONTINENT

Discover the Antarctic Peninsula, where endless white mountains roll to the horizon and massive glaciers churn icebergs into the sea. Travel with a diverse team of experts aboard one of our three state-of-the-art expedition ships. Venture into channels and coves framed by towering peaks. Watch for whales off the bow; glide around enormous icebergs in Zodiacs; and hike, kayak, and even possibly cross-country ski in complete tranquility. Choose an active agenda or surrender to the pleasures of relaxing downtime and shipboard camaraderie. Plus, get top shots with the help of a National Geographic Photography Expert.



### ITINERARY

#### Day 1 Buenos Aires, Argentina or Santiago, Chile

Arrive in Buenos Aires (National Geographic Endurance) or Santiago (National Geographic Resolution).

Transfer from the airport to the Alvear Icon, or similar (National Geographic Endurance) before setting out on a guided tour of the city's Beaux-Arts palaces and parks. Visit Recoleta—the final resting place of Argentina's iconic first lady, Eva Peron—and enjoy a private visit to El Zanon de Granados, one of the city's premier museums.

Or transfer to the Ritz-Carlton, Santiago, or similar (National Geographic

Wild Earth Travel

*Small Ships, Big Adventures*

**0800 945 3327** (within New Zealand) | +64 (0) 3 365 1355 | **1800 107 715** (within Australia)

info@wildearth-travel.com | **wildearth-travel.com**

# Wild Earth Travel

*Small Ships, Big Adventures*

**wildearth-travel.com**

**info@wildearth-travel.com**

Resolution) before our guided overview of this vibrant city backed by the inspiring Andes. Discover sites like the Plaza de Armas and get a feel for the mix of old and new that makes this city so great. In the early evening, we gather for an informal reception and a drink at the hotel.

Arrival Time: Arrive before 11:30 a.m. local time.

Arrival City: Buenos Aires, Argentina or Santiago, Chile

## Day 2 Fly to Ushuaia, Argentina / Embark Ship

Join our recommended flight to Ushuaia; we'll provide transfers to the airport and luggage assistance.\* Sandwiched between ice-mantled peaks and the frigid waters of Beagle Channel, this is a fittingly wild place to be known as "El Fin del Mundo" or "The End of the World." Before departing, visit Tierra del Fuego National Park, clad in dense beech forest just as much of Antarctica was millions of years ago. Savor lunch onboard a private catamaran as you cruise the Channel, keeping an eye out for plump South American sea lions and sleek seabirds like the imperial cormorant. By day's end, you'll be comfortably on board your ship and ready to meet the White Continent.

\*If you are not purchasing our recommended flight, please get in touch with us to confirm your arrangements.

Meals Included: Breakfast, Lunch, Dinner

## Days 3-4 At Sea Crossing the Drake Passage

At times ferocious, at others flat calm, this legendary 500-mile-wide strait divides South America from the Antarctic Peninsula. Feel the excitement build as we begin the crossing, often accompanied by seabirds like the wandering albatross and—if luck allows—a pod of killer whales or rare dolphins. Get to know the ship and prepare for the adventures ahead. Visit the Bridge (ideal for wildlife spotting), relax with a massage, attend a talk on the unique biology of penguins. Or simply settle into a comfy chair in the observation lounge, looking out over the waves as you contemplate the history of this passage named for English privateer Francis Drake, but first discovered by Spanish navigator Francisco de Hoces.

Meals Included: Breakfast, Lunch, Dinner

## Days 5-9 Exploring Antarctica

With long hours of daylight at this time of year, we have ample opportunities to explore. Our schedule is flexible, allowing us to take advantage of the unexpected, whether we're watching whales at play off the bow of our ship, hiking alongside penguin highways, or enjoying an evening Zodiac cruise amid porpoising penguins. While wildlife is magnificent, ice defines the Antarctic. You'll get to know ice up close and personal - from icebergs the size of islands, bergy bits and near-vertical glaciers, to the fragile, nearly invisible layers that have just begun to freeze. One day, we might set out by kayak to encounter towering icebergs at water level; embark on a Zodiac excursion in search of seals and blue-eyed shags; or walk amid thousands of Adelie and gentoo penguins. The next, we might experience the thrill of the ship crunching through pack ice. Everywhere we go in Antarctica we're surrounded by opportunities to capture uniquely beautiful images. Along the way your expert expedition team will enrich our experiences.

Meals Included: Breakfast, Lunch, Dinner

## Days 10-11 At Sea

Enjoy the ship's amenities as the coast of Antarctica disappears from view. Round the southernmost tip of South America and see the meeting of the Atlantic and Pacific Oceans. Take some time to go through your photos, or send a message home to friends and family. Celebrate your voyage at a farewell dinner on board.

Meals Included: Breakfast, Lunch, Dinner

## Day 12 Ushuaia / Disembark Ship / Buenos Aires or Santiago

Disembark in Ushuaia, and join our recommended flight to Buenos Aires or Santiago to connect with your flight home; we'll provide transfers to the airport and luggage assistance.\*

\*If you are not purchasing our recommended flight, please get in touch with us to confirm your arrangements.

Wild Earth Travel  
*Small Ships, Big Adventures*

**0800 945 3327** (within New Zealand) | +64 (0) 3 365 1355 | **1800 107 715** (within Australia)

info@wildearth-travel.com | wildearth-travel.com



# Wild Earth Travel

*Small Ships, Big Adventures*



**wildearth-travel.com**

**info@wildearth-travel.com**

Departure Time: Depart after 9:00 p.m. local time.

Departure City: Buenos Aires, Argentina, or Santiago, Chile

Meals Included: Breakfast

**Please Note:**

Some departures may have a slightly modified itinerary. Please confirm departure and arrival cities with an Expedition Specialist before booking your flights.



**Wild Earth Travel**

*Small Ships, Big Adventures*

**0800 945 3327** (within New Zealand) | +64 (0) 3 365 1355 | **1800 107 715** (within Australia)

info@wildearth-travel.com | **wildearth-travel.com**



# Wild Earth Travel

*Small Ships, Big Adventures*

**wildearth-travel.com**

**info@wildearth-travel.com**

## YOUR SHIP: NATIONAL GEOGRAPHIC ENDURANCE

<b>YOUR SHIP:</b>	<b>National Geographic Endurance</b>
<b>VESSEL TYPE:</b>	<b>Expedition Ship</b>
<b>LENGTH:</b>	<b>124 m</b>
<b>PASSENGER CAPACITY:</b>	<b>126</b>
<b>BUILT/REFURBISHED:</b>	<b>2020</b>

National Geographic Endurance is a state-of-the-art expedition vessel purpose-built for year-round polar navigation. Named in honour of Sir Ernest Shackleton's legendary Endurance expedition, she is the first polar ship in Lindblad's history designed from the keel up for exploration. With an ice-class rating of PC5 (Category A) and a fully stabilised hull, she grants access to remote and often uncharted corners of the Arctic and Antarctica in exceptional comfort and safety.

Her revolutionary X-Bow®--a striking forward-leaning design--enables superior wave-cutting performance, ensuring a smoother, quieter ride and minimising spray on deck for better wildlife observation. On board, guests enjoy thoughtfully designed public spaces including a wraparound observation lounge, library, and an expedition base for gear and briefings. Dining is offered across three flexible venues, all serving sustainable, locally inspired cuisine. With a full suite of tools for exploration and a design deeply rooted in expedition heritage, Endurance is the ultimate platform for discovering Earth's most remote regions.



Wild Earth Travel

*Small Ships, Big Adventures*

**0800 945 3327** (within New Zealand) | +64 (0) 3 365 1355 | **1800 107 715** (within Australia)

info@wildearth-travel.com | wildearth-travel.com

# Wild Earth Travel

*Small Ships, Big Adventures*

[wildearth-travel.com](http://wildearth-travel.com)

[info@wildearth-travel.com](mailto:info@wildearth-travel.com)

## INSIDE YOUR SHIP

### Observation Deck

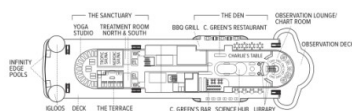

### Bridge Deck

Category 5  
Category 6  
Category 7



### Lounge Deck

Category 4  
Category B Solo



### Main Deck

Category 3  
Category 2 Solo



### Fore Deck

Category 1  
Category 2



### Expedition Deck



### Category 1. From



Wild Earth Travel

*Small Ships, Big Adventures*

0800 945 3327 (within New Zealand) | +64 (0) 3 365 1355 | 1800 107 715 (within Australia)

[info@wildearth-travel.com](mailto:info@wildearth-travel.com) | [wildearth-travel.com](http://wildearth-travel.com)



# Wild Earth Travel

*Small Ships, Big Adventures*



**wildearth-travel.com**

**info@wildearth-travel.com**

## PRICING

### 09-Dec-2025 to 20-Dec-2025

Category 1. From	22811 AUD pp
More Cabin Categories & Prices Available	0 pp

### 17-Dec-2025 to 28-Dec-2025

Category 3	26199 AUD pp
Category 1. From	30534 AUD pp
More Cabin Categories & Prices Available	0 pp

### 29-Dec-2025 to 09-Jan-2026

Category 1. From	30534 AUD pp
More Cabin Categories & Prices Available	0 pp

### 08-Jan-2026 to 19-Jan-2026

Category 1. From	26370 AUD pp
More Cabin Categories & Prices Available	0 pp

### 18-Jan-2026 to 29-Jan-2026

Category 1. From	31420 AUD pp
More Cabin Categories & Prices Available	0 pp

### 12-Dec-2026 to 23-Dec-2026

Category 1. From	20559 AUD pp
More Cabin Categories & Prices Available	0 pp



Wild Earth Travel

*Small Ships, Big Adventures*

**0800 945 3327** (within New Zealand) | +64 (0) 3 365 1355 | **1800 107 715** (within Australia)

info@wildearth-travel.com | wildearth-travel.com