

Wild Earth Travel

Small Ships, Big Adventures

wildearth-travel.com

info@wildearth-travel.com

CROSSING THE ANTARCTIC CIRCLE - USHUAIA ROUNDTRIP CRUISE

Crossing the Antarctic Circle at the 66th southern parallel, you enter what feels like another world, connecting with your inner explorer. It's a space rarely navigated, with narrower channels that bring you closer to ice floes, snow-capped mountain peaks and wondrous icebergs. As you join the Order of the Red Nose, you will explore the Antarctic Peninsula and the South Shetland Islands with the guidance of an expert expedition team. A sense of awe swells within as you come within a safe distance of incredible wildlife like chinstrap penguins or Weddell seals, a serene moment that leaves you feeling more in community with nature. Watch the waters closely and have your camera ready when expedition team members call out humpback whale sightings, an experience best shared with like-minded explorers. On a Zodiac safari through icy waters, the mesmerizing blue within the icebergs invites you to marvel upon them in wonder.



ITINERARY

Day 1 Ushuaia, Argentina Depart: 6:00 pm

Although its nickname the "End of the World" - derived from its location along the southernmost tip of South America among the Tierra del Fuego archipelago - Ushuaia is far from the end of any adventure. Where the Andes meet the Beagle Channel and the snow-capped Martial Mountains sit behind a sprawling city of colorful buildings, lies a lively town ready and waiting to take you on the thrill ride of a lifetime. Scenes like Parque Yatana give you the chance to immerse yourself in the rich, indigenous culture.

Days 2 - 3 Drake Passage Navigation

Navigating the intrepid Drake Passage is made for the boldest of explorers.

Wild Earth Travel

Small Ships, Big Adventures

0800 945 3327 (within New Zealand) | +64 (0) 3 365 1355 | 1800 107 715 (within Australia)

info@wildearth-travel.com | wildearth-travel.com

Wild Earth Travel

Small Ships, Big Adventures

wildearth-travel.com

info@wildearth-travel.com

Petrels and albatrosses that glide across the skies guide the way. To witness its awesome power makes the journey to Antarctica all the more triumphant.

The Drake Passage leads you from the southernmost region of the Americas to the Antarctic Peninsula, the northern point of The White Continent. This waterway where cold southern ocean meets warm northern sea water creates powerful currents that test your mettle.

But the rewards for the journeyer that braves these waters do not compare. The meeting of warm and cold waters creates an environment that attracts extraordinary wildlife. Drake Passage offers the chance to witness the likes of humpback whales and hourglass dolphins that accompany the voyage. The soundtrack of the 48-hour journey through the Drake Passage includes the crash of the ocean against the ship and the cry of petrels, skuas, and gulls.

While the waterway is famous for its challenging navigation, you may still get another side of the Drake Passage. On some occasions, the channel is calm and tranquil, making for a pleasant voyage into Antarctica. That's one of the more splendid characteristics of the Drake Passage - you never know what you will get.

As you emerge from the Drake Passage, the mammoth, icy peaks of the South Shetland Islands loom ahead, greeting you on your victorious landing. You have completed the rite of passage to explore the seventh continent.

Day 4 Crossing the Antarctic Circle – Captain's Choice

As you cross the Antarctic Circle at the 66th southern parallel, you enter what feels like another world, creating a connection with your inner explorer spirit. It's a space rarely navigated, with narrower channels that bring you closer to ice floes, snow-capped mountain peaks and wondrous icebergs, making for a picture-perfect scene. When you do make the crossing, you join the Order of the Red Nose, the select few who navigate deep into the furthest reaches of The White Continent, an unbeatable feeling of triumph.

CAPTAIN'S CHOICE - The Antarctic Circle Crossing may be attempted on a different date during the expedition than indicated on the itinerary due to changing conditions. Expeditions at certain times of the season are not guaranteed to cross the circle as they depend on weather and ice conditions that may limit the ability to navigate that far south. Your Captain will expertly navigate ice floes, icebergs and changing sea and weather conditions to

ensure you experience the most from your expedition. Each day is a new adventure filled with a spontaneous sense of exploration as your Captain works with our expedition team to determine possible shore landings and Zodiac safaris. All itinerary routes serve as examples and are subject to change based on current conditions, prioritizing the safety and optimal expedition experience for all guests..

Days 5 - 7 Exploring the Antarctic Peninsula – Captain's Choice

Nicknamed The White Continent for its vast expanse of icebergs, snow and glaciers, Antarctica is often the final frontier for experienced explorers to conquer. As you navigate Antarctic waters, you may set foot on sites like Beak Island, Brown Bluff, Cierva Cove, Hidden Bay and many more. Each landing throughout the continent offers its own unique landscape, from expansive tundra to rugged mountain peaks, all beckoning you to follow the paths that few explorers have trekked before.

CAPTAIN'S CHOICE -- Your Captain will expertly navigate ice floes, icebergs and changing sea and weather conditions to ensure you experience the most from your expedition. Each day is a new adventure filled with a spontaneous sense of exploration as your Captain works with our expedition team to determine possible shore landings and Zodiac safaris. All itinerary routes serve as examples and are subject to change based on current conditions, prioritizing the safety and optimal expedition experience for all guests.

Days 8 - 9 Exploring the South Shetland Islands - Captain's Choice, Antarctica

Part of the greater Antarctica region, the South Shetland Islands contain plenty of wildlife, scenic landscapes, hiking opportunities and magnificent viewpoints that inspire a sense of discovering another world. A possible landing on Elephant Island, named for the shape of its cliffside and the elephant seals that call it home, puts you on the same path as the famous Shackleton Expedition. Deception Island, another possible landing and named for its very nature, is in fact a volcanic caldera where you can find heated springs amid the striking black sands. Other stops could include Half Moon Island, Yankee Harbor, Point Wild and Barrientos Island, where you can find plenty of Gentoo

Wild Earth Travel

Small Ships, Big Adventures

0800 945 3327 (within New Zealand) | +64 (0) 3 365 1355 | 1800 107 715 (within Australia)

info@wildearth-travel.com | wildearth-travel.com

Wild Earth Travel

Small Ships, Big Adventures



wildearth-travel.com

info@wildearth-travel.com

penguin rookeries.

CAPTAIN'S CHOICE -- Your Captain will expertly navigate ice floes, icebergs and changing sea and weather conditions to ensure you experience the most from your expedition. Each day is a new adventure filled with a spontaneous sense of exploration as your Captain works with our expedition team to determine possible shore landings and Zodiac safaris. All itinerary routes serve as examples and are subject to change based on current conditions, prioritizing the safety and optimal expedition experience for all guests.

Days 10 - 11 Drake Passage Navigation

Navigating the intrepid Drake Passage is made for the boldest of explorers. Petrels and albatrosses that glide across the skies guide the way. To witness its awesome power makes the journey to Antarctica all the more triumphant.

The Drake Passage leads you from the southernmost region of the Americas to the Antarctic Peninsula, the northern point of The White Continent. This waterway where cold southern ocean meets warm northern sea water creates powerful currents that test your mettle.

But the rewards for the journeyer that braves these waters do not compare. The meeting of warm and cold waters creates an environment that attracts extraordinary wildlife. Drake Passage offers the chance to witness the likes of humpback whales and hourglass dolphins that accompany the voyage. The soundtrack of the 48-hour journey through the Drake Passage includes the crash of the ocean against the ship and the cry of petrels, skuas, and gulls.

While the waterway is famous for its challenging navigation, you may still get another side of the Drake Passage. On some occasions, the channel is calm and tranquil, making for a pleasant voyage into Antarctica. That's one of the more splendid characteristics of the Drake Passage - you never know what you will get.

As you emerge from the Drake Passage, the mammoth, icy peaks of the South Shetland Islands loom ahead, greeting you on your victorious landing. You have completed the rite of passage to explore the seventh continent.

Day 12 Ushuaia, Argentina

Although its nickname the "End of the World" - derived from its location along the southernmost tip of South America among the Tierra del Fuego archipelago - Ushuaia is far from the end of any adventure. Where the Andes meet the Beagle Channel and the snow-capped Martial Mountains sit behind a sprawling city of colorful buildings, lies a lively town ready and waiting to take you on the thrill ride of a lifetime. Scenes like Parque Yatana give you the chance to immerse yourself in the rich, indigenous culture.

Please note:

Itineraries are subject to change.

Wild Earth Travel

Small Ships, Big Adventures

0800 945 3327 (within New Zealand) | +64 (0) 3 365 1355 | 1800 107 715 (within Australia)

info@wildearth-travel.com | wildearth-travel.com



Wild Earth Travel

Small Ships, Big Adventures



wildearth-travel.com

info@wildearth-travel.com

YOUR SHIP: WORLD VOYAGER

YOUR SHIP:	World Voyager
VESSEL TYPE:	Yacht
LENGTH:	129 m
PASSENGER CAPACITY:	198
BUILT/REFURBISHED:	2022

Experience extraordinary Antarctica to the fullest and in the shortest amount of time aboard our newest yacht. Spend more time exploring the Antarctic Peninsula by flying over the Drake Passage one way and still lay claim to the iconic experience of sailing the other direction with our options. Or, if you're an intrepid explorer, you can still conquer the famed Drake Passage both ways with all Ushuaia Roundtrip expeditions.

YOUR SANCTUARY AT SEA After a day of roaming, venturing and exploring, indulge in the comfort of a balcony accommodation or modern suite -- plus accommodations exclusively for solo travelers. Every room features a spacious bathroom outfitted with L'OCCITANE amenities, plush bedding designed for dreaming, flat-screen TVs with state-of-the-art infotainment systems for downtime and sitting or living areas to unwind. Gaze at the horizon as you replay the adventures of the day.

TASTE PERFECTION When dining goes beyond simply being a meal and becomes an experience you look forward to every day, both your appetite and your soul are satiated. Our onboard dining options offer extraordinary culinary adventures with globally inspired gourmet cuisine artfully crafted to awaken your senses one delectable morsel at a time. From Portuguese soul

food alfresco with an ocean view to breakfast in bed before embarking on your next endeavors, every detail is taken into careful consideration to deliver an upscale experience with simple elegance.

ONBOARD LIFE At Atlas Ocean Voyages, we encourage a holistic approach to life that incorporates mind, body and spirit. Connect with like-spirited explorers during Apres Sea and satisfy your curiosity with exceptional guest lecturers to relish every aspect of a stimulating journey. From appreciating the dining experience to keeping up an exercise routine while on holiday to taking time for self-care, we cultivate an atmosphere of overall well-being in every space on board World Voyager.

MAKE YOURSELF AT HOME Aboard our intimate, yacht World Voyager you will find everything you want and need. Including three decks of spacious and elevated accommodations, various onboard dining options, spa and sauna amenities, social spaces for gathering with your fellow travelers and more, World Voyager has been designed to always deliver relaxed luxury and highly personalized service.

CONSCIOUS NAVIGATION An innovative hydro-jet propulsion system allows the purpose-built World Voyager to bring you closer to the environment and wildlife. The system gives the ship a quieter sound that's less disruptive to the ecosystem, making for up-close and personal encounters that leave you in awe.



Wild Earth Travel
Small Ships, Big Adventures

0800 945 3327 (within New Zealand) | +64 (0) 3 365 1355 | 1800 107 715 (within Australia)

info@wildearth-travel.com | wildearth-travel.com



Wild Earth Travel

Small Ships, Big Adventures



wildearth-travel.com

info@wildearth-travel.com



you in awe.

Wild Earth Travel

Small Ships, Big Adventures

0800 945 3327 (within New Zealand) | +64 (0) 3 365 1355 | 1800 107 715 (within Australia)

info@wildearth-travel.com | wildearth-travel.com

Wild Earth Travel

Small Ships, Big Adventures

wildearth-travel.com

info@wildearth-travel.com

INSIDE YOUR SHIP

ADVENTURE OCEANVIEW STATEROOM (AO)

DISCOVERY SUITE (DS)

WORLDVOYAGER™
WORLDTRAVELLER™
WORLDNAVIGATOR™

DECK 8
DECK 7
DECK 6
DECK 5
DECK 4
DECK 3



HORIZON DELUXE STATEROOM (E1)

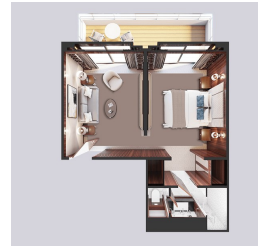

HORIZON STATEROOM (A)

HORIZON STATEROOM (A)

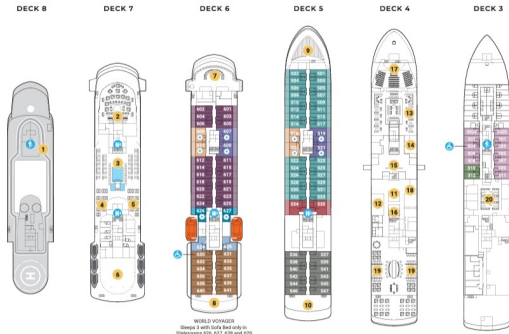

DECK 8
1 RUNNING TRAIL
OUTDOOR FV
DECK 7
2 THE DOME
3 POOL & HOT
4 7-AFT GRILL
5 7-AFT POOL
6 ZODIAC STG
DECK 6
7 BRIDGE
8 SMALL SUNB
DECK 5
9 WATER'S EDGE
10 ZEPHYR LOU
DECK 4
11 PAUL'S PAN
12 FITNESS STU
13 ATLAS LOUN
14 MEDICAL CEN
15 RECEPTION
16 BOUTIQUE
17 AUDITORIUM
18 VERANDA
19 MAIN RESTAURANT - INDOOR/ALFRESCO
DECK 3
20 MAID ROOM



JOURNEY SUITE (JS)



NAVIGATOR SUITE (NS)

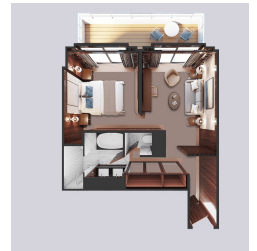
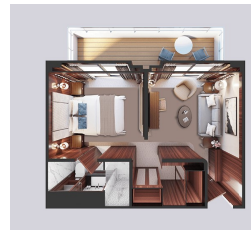

SUITES	STATEROOMS	SYMBOLS	SPECIFICATIONS
NAVIGATOR (NS) DISCOVERY (DS) JOURNEY (JS)	HORIZON DELUXE (E1) VERANDA DELUXE (E2) HORIZON (A1) HORIZON (A2)	VERANDA (B1) VERANDA (B2) ADVENTURE (AO) SOLID (SO)	OVERALL LENGTH: 120m/393' BEAM (WIDTH): 18.9m/62' GROSS TONNAGE: 10,000 GUEST DECKS: 6
		SLEEPS 3 WITH SOFA BED ELEVATOR/STAIRS STAIRS ACCESSIBLE STATEROOMS	ACCOMMODATION: GUEST CABINS CRUISE SHIPS

Wild Earth Travel
Small Ships, Big Adventures

0800 945 3327 (within New Zealand) | +64 (0) 3 365 1355 | 1800 107 715 (within Australia)

info@wildearth-travel.com | wildearth-travel.com

Wild Earth Travel

Small Ships, Big Adventures



wildearth-travel.com

info@wildearth-travel.com

PRICING

02-Feb-2026 to 13-Feb-2026

VERANDA STATEROOM (B1/B2)	28499 USD pp
HORIZON STATEROOM (A1/A2)	28499 USD pp
ADVENTURE OCEANVIEW STATEROOM (A0)	28499 USD pp
VERANDA DELUXE STATEROOM (E2)	34399 USD pp
HORIZON DELUXE STATEROOM (E1)	34399 USD pp
JOURNEY SUITE (JS)	37099 USD pp
DISCOVERY SUITE (DS)	39099 USD pp
NAVIGATOR SUITE (NS)	41099 USD pp

Government Taxes and Fees 550

ADDITIONAL CHARGES:

USD pp

Wild Earth Travel

Small Ships, Big Adventures

0800 945 3327 (within New Zealand) | +64 (0) 3 365 1355 | 1800 107 715 (within Australia)

info@wildearth-travel.com | wildearth-travel.com