

Wild Earth Travel

Small Ships, Big Adventures

wildearth-travel.com

info@wildearth-travel.com

ANTARCTICA, SOUTH GEORGIA, AND THE FALKLANDS EXPEDITION CRUISE

This voyage has it all: the impossible beauty of the Antarctic ice, the vast king penguin colonies of South Georgia, and the Falklands' amazing albatross colonies. Not even the mass migrations of Africa can rival the awesomeness of seeing a king penguin colony of tens of thousands individuals stretching as far as the eye can see. You'll have other rare sightings here too: massive, in both senses of the word, herds of elephant seals; and a wandering albatross stretching its 11-foot wings. It's the impossible beauty of an Antarctica trip exponentially increased by unimaginable numbers of animals. For most travelers, visiting Antarctica is a once-in-a-lifetime experience. So for those with the luxury of time, including the Falklands and South Georgia just makes sense. And it makes for a genuine experience of a lifetime.



ITINERARY

DAY 1 Buenos Aires, Argentina, or Santiago, Chile

Arrive in Buenos Aires (National Geographic Explorer & National Geographic

Wild Earth Travel

Small Ships, Big Adventures

0800 945 3327 (within New Zealand) | +64 (0) 3 365 1355 | **1800 107 715** (within Australia)

info@wildearth-travel.com | wildearth-travel.com



Wild Earth Travel

Small Ships, Big Adventures

wildearth-travel.com

info@wildearth-travel.com

Endurance) or

Santiago (National Geographic Resolution).

Transfer from the airport to the Alvear Art Hotel or similar (National Geographic Explorer), or Alvear Icon or similar (National Geographic Endurance) before setting out on a guided tour of the city's Beaux-Arts palaces and parks. Visit Recoleta--the final resting place of Argentina's iconic first lady, Eva Peron--and enjoy a private visit to El Zanon de Granados, one of the city's premier museums.

Or, transfer to the Ritz-Carlton, Santiago, or similar (National Geographic Resolution) before our guided overview of this vibrant city backed by the inspiring Andes. Discover sites like the Plaza de Armas and get a feel for the mix of old and new that makes this city so great.

In the early evening, gather for an informal reception and drink at the hotel.

Arrival Time: Arrive before 11:30 a.m. local time.

Arrival City: Buenos Aires, Argentina or Santiago, Chile

DAY 2 Ushuaia, Argentina / Embark Ship

Today we fly south to Ushuaia, the southernmost city in the world, where we meet our ship. Ushuaia's spectacular setting, between the jagged peaks of the Darwin Range and the protected waters of the Beagle Channel, makes it an appropriately wild place to begin our journey to the White Continent and a great destination in its own right. Lunch will be served onboard a private catamaran while cruising the Beagle Channel, where we'll be on the lookout for huge South American sea lions and birds like imperial cormorants. Residents of Ushuaia often call their small city 'El Fin Del Mundo', The End of the World, but for us, it's just the beginning.

Meals Included: Breakfast, Lunch, Dinner

DAYS 3-4 At Sea

This 500-mile-wide strait between South America and the Antarctic Peninsula is one of the most famous bodies of water in the world. Sometimes ferocious, sometimes flat calm, the Drake is always a fascinating place in its own right. This part of the journey is our best opportunity to see gorgeous seabirds like the wandering albatross, and we might be lucky enough to encounter killer whales or rare species of dolphins. This is also a day to get to know our ship and prepare for the adventures ahead. Visit the Bridge (a great place to spot wildlife), have a relaxing massage; attend a talk about the biology of the penguins you'll soon be seeing; or settle into a comfy chair in the observation lounge, look out over the waves, and reflect on the incredible history of this fabled passage. If it does get a little rough, just take a couple of nice naps; we'll be in Antarctica before you know it.

Meals Included: Breakfast, Lunch, Dinner

DAYS 5-9 Antarctica

With long hours of daylight at this time of year, we have ample opportunities to explore. Our schedule is flexible, allowing us to take advantage of the unexpected. We might set out by kayak to encounter towering icebergs at water level; embark on a Zodiac excursion in search of seals and blue-eyed shags; walk amid thousands of Adelie and gentoo penguins; or experience the thrill of the ship crunching through pack ice. Everywhere we go in Antarctica we're surrounded by opportunities to capture uniquely beautiful images. Along the way our expert expedition team will enrich our experiences.

Meals Included: Breakfast, Lunch, Dinner

DAYS 10-11 At Sea

Setting out from the South Shetland Islands to South Georgia, we are following in the wake of Sir Ernest Shackleton's epic voyage in the James Caird across 800 miles of the wild and lonely Scotia Sea. But we won't be lonely at all--these waters are home to a large and growing population of whales, including fin whales, southern right whales and even blue whales--the largest animal on Earth. Albatross and petrels wing past the ship, providing us with another wonderful challenge for photography, while presentations from the



Wild Earth Travel

Small Ships, Big Adventures

wildearth-travel.com

info@wildearth-travel.com

expedition team help to prepare us for the mind-bending wildlife spectacles of South Georgia.

Days at sea are not simply transits from one place to another; they are a very important part of this epic journey in their own right. The crossing from the Antarctic Peninsula to South Georgia gives us a chance to stop and breathe, to explore the amenities of the ship and to spend a little time contemplating all our new memories. Life-changing experiences tend to pile up on one another in the Antarctic, so slow down a bit and let it all settle in. This is a great time to catch up with your journal, enjoy a rejuvenating massage, or download and review all those hundreds (or thousands!) of photos. Get some rest, too--when we get to South Georgia, it's going to be go, go, go!

Meals Included: Breakfast, Lunch, Dinner

DAYS 12-15 South Georgia Island

Simply put, there is nowhere else in the world like South Georgia. King penguins, the second largest species in the world, are unquestionably the most iconic wildlife of South Georgia. Exact numbers are not known, but the largest single colony on the island may have as many as 500,000 of these amazing birds nesting together on a single two-mile-long beach.

Explore the spectacular coastline of South Georgia Island. In keeping with the nature of an expedition, our schedule is flexible with opportunities for walking, hiking, kayaking, and Zodiac excursions. Sailing along the coast, we plan to offer activities every day including visits to Grytviken--the final resting place of Shackleton--and Stromness Harbour, where Ernest Shackleton, Tom Crean, and Frank Worsley finally reached aid at a whaling station.

The island is also home to huge elephant seals and thousands of king penguins. South Georgia is sometimes called "the Serengeti of the Southern Ocean", but even that description seems inadequate; this lonely island is unique in the world, so rich and so beautiful that it defies any comparison.

Meals Included: Breakfast, Lunch, Dinner

DAYS 16-17 At Sea

Our first day at sea on the way to the Falkland Islands is another opportunity to

think back over the adventures of the past few days and make preparations for those soon to come. Spend some time chatting about your latest images with the National Geographic photography expert and learn to make them look their best in the digital darkroom. Put the finishing touches on your watercolor of that amazing iceberg or try to capture an albatross's flight in a poem. Everyone needs to exhale a bit after a visit to South Georgia, so take a little time to explore the details of your own memories and share them with your shipmates.

The Bridge is the nerve center of the ship, in more ways than one. There's always a congenial atmosphere there, whether you've come to ask one of the officers about navigation or just to sit and watch the world go by with binoculars in hand. The waters close to the Falkland Islands are rich with marine wildlife, so this is a great time to hang out with the naturalists and keep watch for rare dolphins or another beautiful species of albatross. All new sightings go up on the white board for the day's record!

Meals Included: Breakfast, Lunch, Dinner

DAYS 18-20 Falkland Islands

Everything we love about expedition travel seems to come together in the western Falkland Islands. Where else can you land on a beach tucked into a rocky cove, hike out across a rolling green pasture, and suddenly find yourself at the crest of a sea cliff looking out over the South Atlantic surf? Just a few steps further and you're standing at the edge of a breeding colony of black-browed albatross, so close that you can hear the wind on their wings as they swoop into land beside you. Check out the thousands of irresistible gentoo, rockhopper, and Magellanic penguins that congregate here, along with fur seals.

Stanley, the bright, pretty capital of the Falkland Islands, is a wonderfully unexpected place: a charming outpost of British culture tucked into a small bay on the shore of these windswept islands in the far South Atlantic. Many Falkland Islanders still live in very traditional ways, and we'll have a chance to visit a small farm to see some expert sheep shearing and learn about the best techniques for cutting blocks of peat for the fire. The rocky hills and white sand beaches outside town offer some excellent hikes, and afterward, a cup of tea or a pint at the local tavern goes down very nicely.

Meals Included: Breakfast, Lunch, Dinner



Wild Earth Travel

Small Ships, Big Adventures



wildearth-travel.com

info@wildearth-travel.com

DAY 21 At Sea

The final day of our expedition takes us across the shallow waters of the Falklands Shelf, back to our starting point in Ushuaia. Attend presentations from the expedition staff on topics that help to sum up all the wonderful details of our experiences in the far south, and spend some time on deck enjoying the seabirds and dolphins that make these seas their home.

This is a day for contemplation as well. The Antarctic stays with you. Sometime soon, at a moment in the midst of a stressful day, you'll remember the feeling of the polar wind, the sight of waves crashing against the blue wall of an iceberg, and the sound of the penguins calling to their chicks. It's a little bit of peace that you'll carry with you always.

Meals Included: Breakfast, Lunch, Dinner

DAY 22 Disembark Ship / Ushuaia / Buenos Aires (National Geographic Explorer / National Geographic Endurance) or Santiago (National Geographic Resolution)

Disembark in Ushuaia. Fly by private charter to Buenos Aires or Santiago and transfer to the airport for your flight home.

Meals Included: Breakfast

Please Note:

Some departures may have a slightly modified itinerary. Please confirm departure and arrival cities with an Expedition Specialist before booking your flights.



Wild Earth Travel

Small Ships, Big Adventures

0800 945 3327 (within New Zealand) | +64 (0) 3 365 1355 | **1800 107 715** (within Australia)

info@wildearth-travel.com | **wildearth-travel.com**

Wild Earth Travel

Small Ships, Big Adventures

wildearth-travel.com

info@wildearth-travel.com

YOUR SHIP: NATIONAL GEOGRAPHIC ENDURANCE

| | |
|----------------------------|--------------------------------------|
| YOUR SHIP: | National Geographic Endurance |
| VESSEL TYPE: | Expedition Ship |
| LENGTH: | 124 m |
| PASSENGER CAPACITY: | 126 |
| BUILT/REFURBISHED: | 2020 |

National Geographic Endurance is a state-of-the-art expedition vessel purpose-built for year-round polar navigation. Named in honour of Sir Ernest Shackleton's legendary Endurance expedition, she is the first polar ship in Lindblad's history designed from the keel up for exploration. With an ice-class rating of PC5 (Category A) and a fully stabilised hull, she grants access to remote and often uncharted corners of the Arctic and Antarctica in exceptional comfort and safety.

Her revolutionary X-Bow®--a striking forward-leaning design--enables superior wave-cutting performance, ensuring a smoother, quieter ride and minimising spray on deck for better wildlife observation. On board, guests enjoy thoughtfully designed public spaces including a wraparound observation lounge, library, and an expedition base for gear and briefings. Dining is offered across three flexible venues, all serving sustainable, locally inspired cuisine. With a full suite of tools for exploration and a design deeply rooted in expedition heritage, Endurance is the ultimate platform for discovering Earth's most remote regions.



Wild Earth Travel

Small Ships, Big Adventures

0800 945 3327 (within New Zealand) | +64 (0) 3 365 1355 | **1800 107 715** (within Australia)

info@wildearth-travel.com | wildearth-travel.com

Wild Earth Travel

Small Ships, Big Adventures

wildearth-travel.com

info@wildearth-travel.com

INSIDE YOUR SHIP

Observation Deck

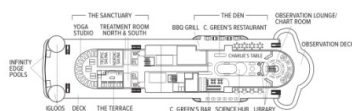

Bridge Deck

- Category 5
- Category 6
- Category 7



Lounge Deck

- Category 4
- Category 8 Solo



Main Deck

- Category 3
- Category 2 Solo



Fore Deck

- Category 1
- Category 2



Expedition Deck



Category 1. From

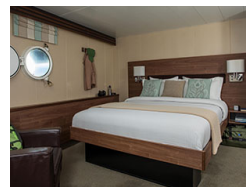

Wild Earth Travel

Small Ships, Big Adventures

0800 945 3327 (within New Zealand) | +64 (0) 3 365 1355 | 1800 107 715 (within Australia)

info@wildearth-travel.com | wildearth-travel.com



Wild Earth Travel

Small Ships, Big Adventures



wildearth-travel.com

info@wildearth-travel.com

PRICING

18-Oct-2025 to 08-Nov-2025

| | |
|--|--------------|
| Category 1. From | 27294 AUD pp |
| Cat SA | 60650 AUD pp |
| More Cabin Categories & Prices Available | 0 pp |

30-Oct-2025 to 20-Nov-2025

| | |
|--|--------------|
| Category 1. From | 31049 AUD pp |
| More Cabin Categories & Prices Available | 0 pp |

07-Feb-2026 to 28-Feb-2026

| | |
|--|--------------|
| Category 1. From | 68701 AUD pp |
| More Cabin Categories & Prices Available | 0 pp |

29-Oct-2026 to 19-Nov-2026

| | |
|--|--------------|
| Category 1. From | 31049 AUD pp |
| More Cabin Categories & Prices Available | 0 pp |

06-Nov-2026 to 27-Nov-2026

| | |
|--|--------------|
| Category 1. From | 31049 AUD pp |
| More Cabin Categories & Prices Available | 0 pp |

12-Nov-2026 to 03-Dec-2026

| | |
|--|--------------|
| Category 1. From | 32337 AUD pp |
| More Cabin Categories & Prices Available | 0 pp |

08-Feb-2027 to 01-Mar-2027

| | |
|--|--------------|
| Category 1. From | 63280 AUD pp |
| More Cabin Categories & Prices Available | 0 pp |

Optional extras & upgrades

Optional tours and excursions available. Please contact us for more details.